

NAEV657A

**ALBA**

***INSTRUCTION BOOKLET***

**CAL. V657 V655 V33J**

V657 CHRONOGRAPH WITH CALENDAR

## ■ FEATURES

ALBA Cal. V657 is an analogue quartz watch featuring a 1/10 second stopwatch function in addition to the time display.

### ● Time

Indicated by the hour, minute, second, and date.

### ● Stopwatch

It can measure up to 60 minutes in 1/10 seconds.

Split time measurement is also possible.

\* "Split time" refers to an elapsed time required to cover a distance from the start to a given point.

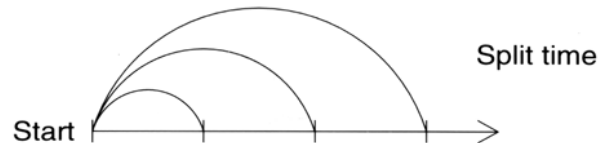

## ■ DISPLAY AND CROWN/BUTTON OPERATION

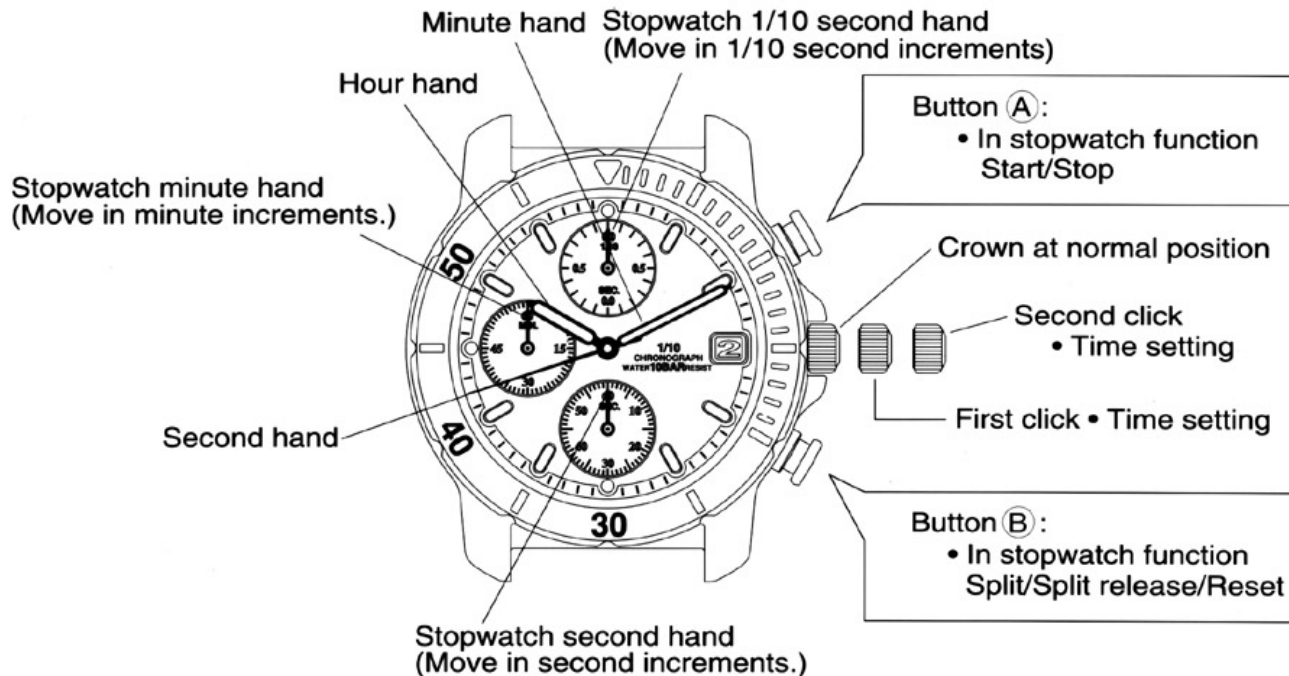

- \* The measured time is indicated by the stopwatch hands that move independently of the center hands.
- \* Stopwatch 1/10 second hand moves for a first minute. After one minute, it indicates the measured time when it is stopped.

## ADJUSTING THE STOPWATCH HAND POSITION

Before setting the time, check if the stopwatch 1/10 second, second and minute hands are in the "0" (12 o'clock) position.

\* If the stopwatch is in use, press the button in the following order to reset it, and then, check if the hands return to "0" position. (For details, see "HOW TO USE THE STOPWATCH".)

- If the stopwatch is counting: (A) → (B)
- If the stopwatch is stopped: (B)
- If the split time is displayed: (B) → (A) → (B)

● If either of the stopwatch hands are not in the "0" position, reset them following the procedure below.

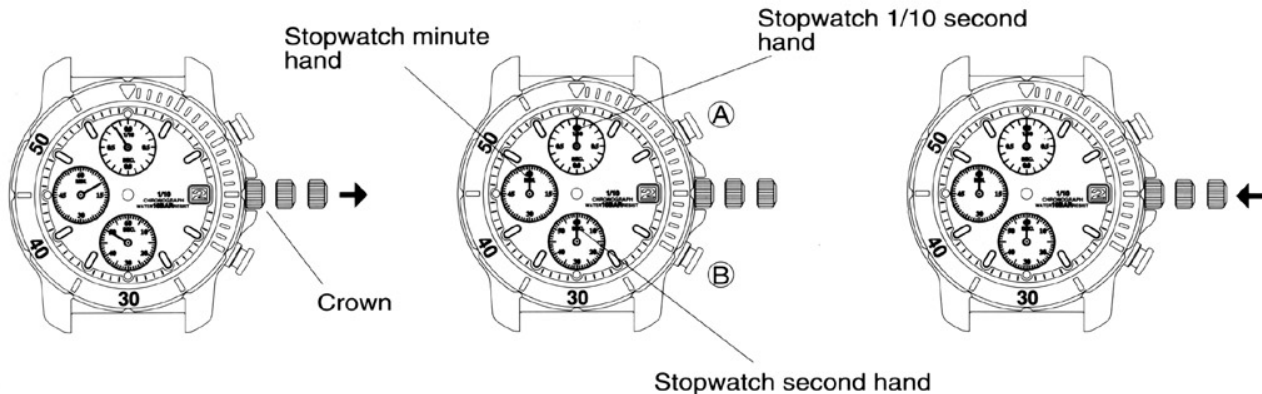

1. Pull the crown out to the second click.

2. Press button (A) or (B) to reset the stopwatch 1/10 second, second, and minute hands to "0" position.

- By pressing button (A), set the stopwatch 1/10 second hand.
- By pressing button (B), set the stopwatch second and minute hands.

3. Push the crown back in to the normal position.

\* The stopwatch minute hand moves correspondingly with the stopwatch second hand.

\* The hands move quickly if the respective buttons are kept pressed.

## TIME/CALENDAR SETTING

\* Before setting the time, check that the chronograph measurement is stopped.

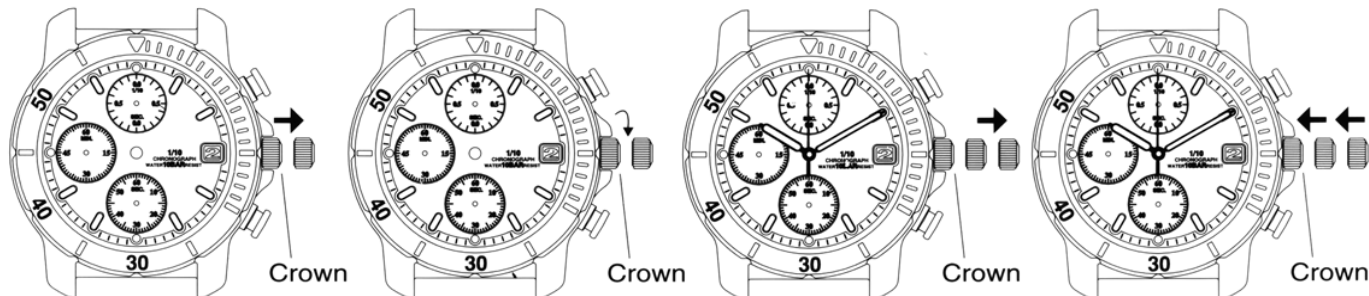

1 Pull out the crown to the first click.

2 Turn the crown clockwise until the previous day's date appears.

3 Pull out the crown all the way to the second click, and advance the hour and minute hands by turning the crown until the desired date appears. And then, set the hands to the desired time by turning the crown. (Check that AM/PM is set correctly.)

4 Push the crown back in to the normal position in accordance with a time signal for "00" seconds.

\* If the crown is of a screw lock type, unscrew it by turning it counterclockwise, and then pull it out to the first click.

\* The crown can be pulled out to the second click. Check that it is pulled out to the first click when you change the date.

\* Date adjustment at the end of the month.  
It is necessary to adjust the date at the end of February and 30-days months or on the first day of March and month following a 30-day month. Please adjust the date.

\* Do not set the date between 9:00 P.M and 1:00 A.M.  
Otherwise, the date may not change properly. If it is necessary to set the date during that time period, first change the time to any time outside it, set the date and then reset the correct time.

\* Pull out the crown to the second click when the second hand is at the 12 o'clock position. It will stop on the spot.

1. First click (Date setting)
2. Second click (Time setting)

\* When the crown is at the second click position, do not press any button. Otherwise, the chronograph hands will move.

(For details, refer to "ADJUSTING THE CHRONOGRAPH HAND POSITION".)

\* If the crown is of a screw lock type, screw it in completely by turning it clockwise while pressing it.  
\* The telephone time signal service [TEL. 117] is helpful in setting the seconds.

## HOW TO USE THE STOPWATCH

- The measured time is indicated by the stopwatch hands that move independently of the center hands.
- The stopwatch can measure up to 60 minutes in 1/10 seconds.

[Standard measurement]

Ex.) 100m race (Press the buttons in the following order: A → A → B)

START → STOP (Finish) → RESET (Reset to "0'00'")

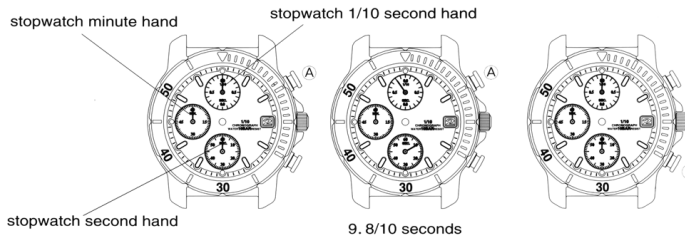

[Accumulated elapsed time measurement]

Ex.) Basketball game (Press the buttons in the following order: A → A / A → ... → A → B)

START → STOP RESTART → ... → STOP → RESET  
 (Start of game) (Time-out) (Restart of game) (Game over)

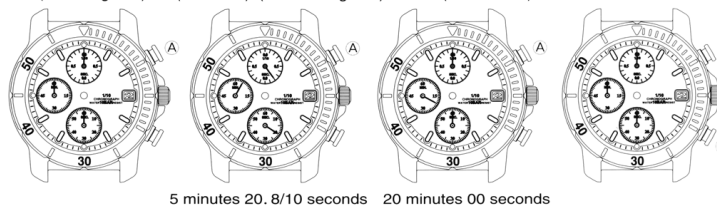

\* Restart and stop of the stopwatch can be repeated as many times as necessary by pressing button A.

[Split time measurement]

Ex.) 5,000m race (Press the buttons in the following order: A → B / B → ... → A → B)

START → SPLIT/SPLIT RELEASE → ... → STOP → RESET  
 (Finish)



\* Measurement and release of the split time can be repeated as many times as necessary by pressing button B

## ■ RESETTING THE IC

When the battery is replaced with a new one, the time information stored in the built-in IC and the time indicated by the stopwatch hands do not correspond with each other.

Reset the stopwatch hands to "0" position following the procedure below.

If the stopwatch hands should move improperly, also follow the same procedure.

Stopwatch minute hand      Stopwatch 1/10 second hand

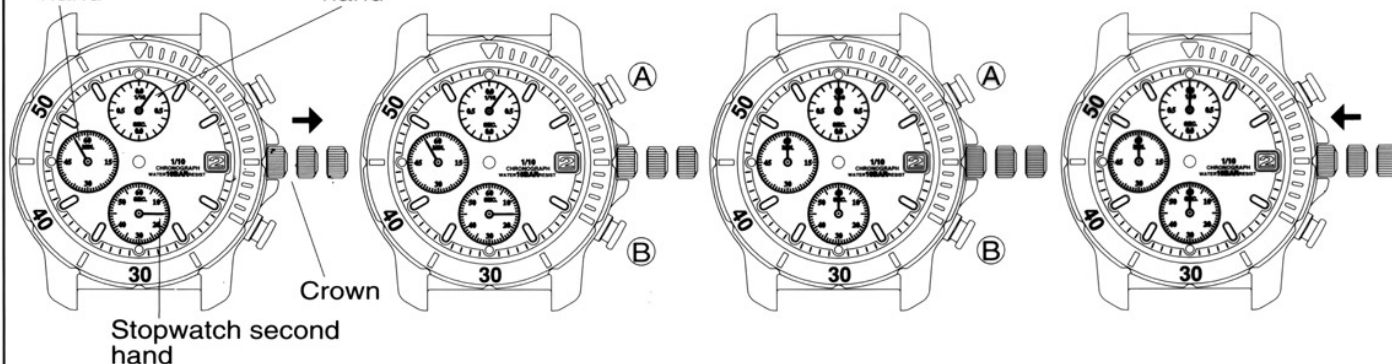

- 1 Pull the crown out to the second click.
- 2 Keep buttons "A" and "B" pressed at the same time for 2 seconds, and then, release the buttons.  
The stopwatch second hand move back and returns to where it was.
- 3 Press button "A" or "B" to reset the stopwatch hands to "0" position.
  - By pressing button "A", set the stopwatch 1/10 second hand.
  - By pressing button "B", set the stopwatch second and minute hands.
- 4 Turn the crown to set the hour, and minute hands to the desired time, and push the crown back in to the normal position.  
(For details, refer to "TIME SETTING".)

\* The stopwatch minute hand moves correspondingly with the stopwatch second hand.

\* The hands move quickly if the respective buttons are kept pressed.