

ALBA

INSTRUCTION BOOKLET CAL. 5Y85

■ CHARACTERISTICS

- Time indicates by the hour, minute and second hands
- Date indicates by the date hand
- Day of the week indicates by the day hand
- The 24-hour hand indicates the hour in the 24-hour indication

■ DISPLAY AND CROWN OPERATION

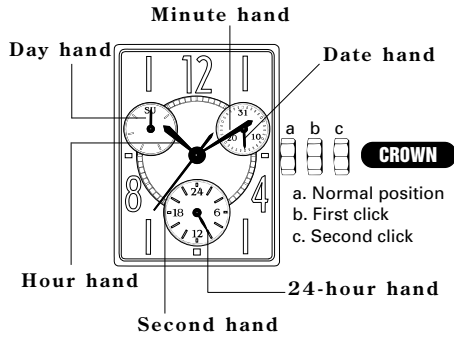

SCREW DOWN CROWN

[for models with screw down crown]

Unlocking the crown

- 1 Turn Crown counterclockwise until you no longer feel the threads turning.
- 2 Crown can be pulled out.



Locking the crown

- 1 Push Crown back in to normal position.
- 2 Turn Crown clockwise while pressing it lightly until tight.



■ TIME, DAY AND 24-HOUR HAND SETTING

TIME SETTING

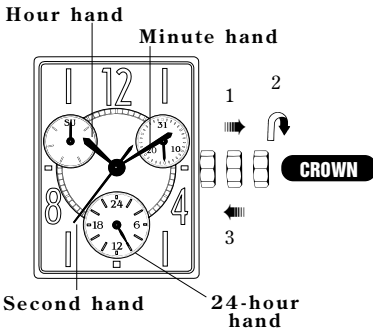

- 1 Pull out the crown all the way to the second click when the second hand is at the 12 o'clock position. The second hand will stop on the spot.
- 2 Turn the crown to set the time and 24-hour hand.

* As the hour and minute hands move, the 24-hour hand changes correspondingly.

- 3 Push the crown back into the normal position in accordance with a time signal.

DAY SETTING

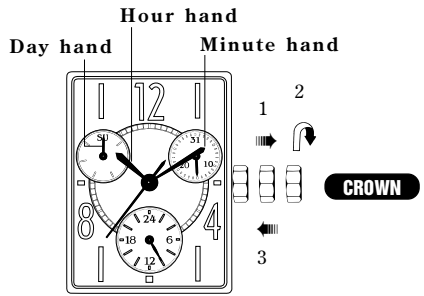

- 1 Pull out the crown to the second click.
- 2 Turn the crown clockwise to advance the hour and minute hands until the day hand is advanced to the desired day.

* The day hand will not move back.

- 3 Push the crown back into the normal position.

■ HOW TO SET THE DATE

SETTING THE DATE

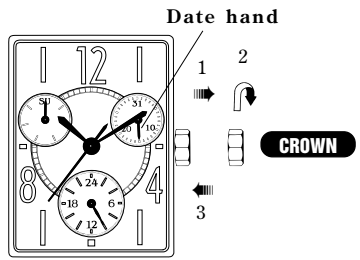

- 1 Pull out the crown to the first click.
- 2 Turn the crown clockwise to set the date hand to the desired date.
- 3 Push in.

■ NOTES ON OPERATING THE WATCH

TIME/DATE SETTING

- When setting the hour hand and 24-hour hand, check that AM/PM is correctly set. The watch is so designed that the date and day change once in 24 hours.
- When setting minute hand, first advance it 4 to 5 minutes ahead of the desired time and then turn it back to the exact minute.
- When setting the date, be careful not to pull out the crown to the second click instead of the first click. Otherwise, the second hand stops and the time setting is made necessary.
- To advance the day hand quickly, turn back the hour and minute hands about four hours after the day changes to the next, and then advance them again until the day hand is set to the next.

3
Years

Battery life : Approx. 3 years
Battery : SR916SW

- As the battery is inserted at the factory to check the function and performance of the watch, its actual life once in your possession may be less than the specified period.
- When the battery expires, be sure to replace it as soon as possible to prevent any malfunction.
- We recommend that you contact an AUTHORIZED ALBA DEALER for battery replacement.

WARNING

- Do not remove the battery from the watch.
- If it is necessary to take out the battery, keep it out of the reach of children. If a child swallows it, consult a doctor immediately.
- Never short-circuit, tamper with or heat the battery, and never expose it to fire. The battery may burst, become very hot or catch fire.

CAUTION

- The battery is not rechargeable. Never attempt to recharge it, as this may cause battery leakage or damage to the battery.